



MOTION PRO, INC.  
3171 Swetzer Road  
Loomis, CA 95650  
Tel 650.594.9600 Fax 650.594.9610  
www.motionpro.com

# INSTRUCTIONS

## Motion Pro Soter Fueling System™: 08-0662 and 08-0680 Probe Servicing

### 08-0662 Probe Assembly

#### WARNING:

When servicing these components be away from open flame or sparks, protect skin from gasoline and other chemicals. Wear safety glasses. Test function before putting system back in service

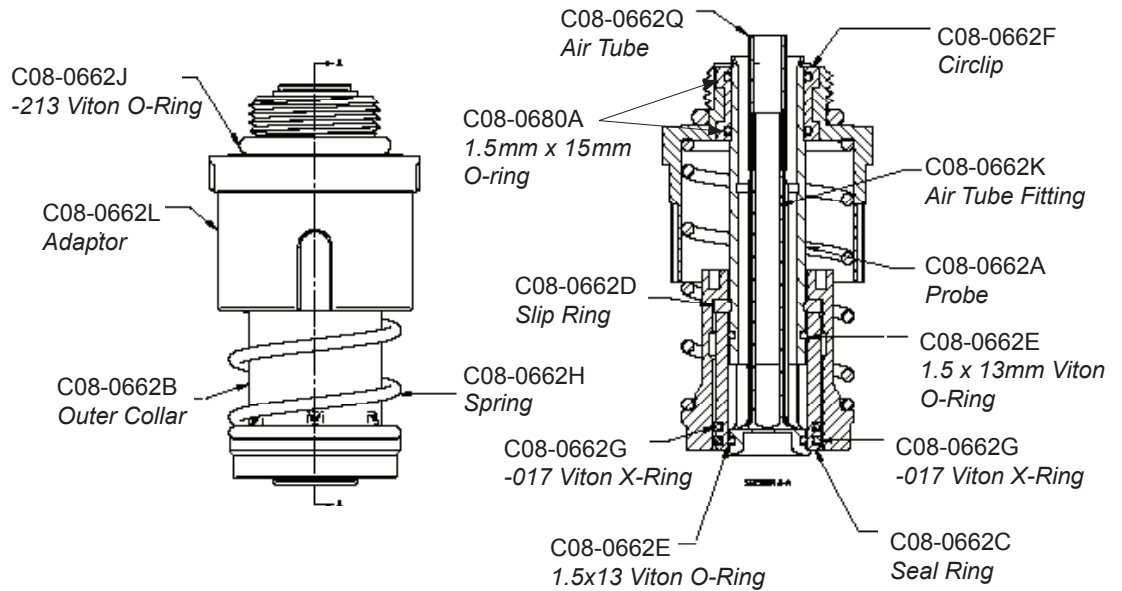

### Disassembly



1. Carefully remove the circlip using external circlip pliers, simultaneously holding the adaptor securely to prevent the spring from ejecting the adaptor from the probe.



2. Separate the adaptor from the probe. The spring, outer collar, slip ring, and seal ring may now be removed from the assembly. Clean all parts using contact or brake cleaner and compressed air. Carefully inspect all components for wear or damage, and replace if necessary.

### Assembly

Reassemble the probe in reverse order of disassembly. Lubricate all O-Rings with a light coat of seal grease. 2-stroke oil or bar oil can be used if seal grease is not available. Make sure the circlip is fully seated in its groove after assembly.



visit [motionpro.com/c/soter-fueling-system](http://motionpro.com/c/soter-fueling-system) for more information

or Scan QR code for soter fueling system™ resources

Access documents and view the video available:  
[Motion Pro Soter Fueling System Introduction](#)



Note: Most smartphone cameras will scan qr codes